



Speedheater Infrared Paint Remover, Model 1100

INSTRUCTION & SAFETY MANUAL



Removedor de Pintura Infrarrojos, Modelo 1100

MANUAL DE INSTRUCCIONES Y SEGURIDAD



Décapeur infrarouge Speedheater, Modèle 1100

MODE D'EMPLOI ET CONSIGNES DE SÉCURITÉ

English

Español

Français

TABLE OF CONTENTS

Page

SAFETY PRECAUTIONS

5 - 8

TECHNICAL SPECIFICATIONS

9

INSTRUCTIONS FOR USE

11 - 14

TROUBLESHOOTING GUIDE

15

CLEANING AND MAINTENANCE, CHANGING IR TUBES

16 - 17

SPARE PARTS LIST

18

WARRANTY

19 - 20

THIS TOOL SOFTENS PAINT, VARNISH AND PUTTY, ENABLING IT TO BE SCRAPED OFF EASILY. USE A HIGH QUALITY SCRAPER WITH THIS TOOL. DO NOT LEAVE UNATTENDED.

LIKE ANY POWER TOOL IT CAN BE DANGEROUS NOT USED PROPERLY.

READ THE FOLLOWING INSTRUCTIONS CAREFULLY AND FOLLOW ALL SAFETY PRECAUTIONS.

IT IS THE RESPONSIBILITY OF THE OWNER TO USE THE SPEEDHEATER INFRARED PAINT REMOVER, MODEL 1100 PROPERLY.

BASIC SAFETY INSTRUCTIONS SHOULD ALWAYS BE FOLLOWED WHEN USING THIS ELECTRICAL TOOL IN ORDER TO REDUCE THE RISK OF FIRE, ELECTRIC SHOCK AND PERSONAL INJURY.

THIS INSTRUCTION & SAFETY MANUAL IS NOT INTENDED TO SERVE AS WARRANTY, GUARANTEE OR REPRESENTATION CONCERNING THE FUNCTION AND OPERATION OF THE SPEEDHEATER INFRARED PAINT REMOVER, MODEL 1100.

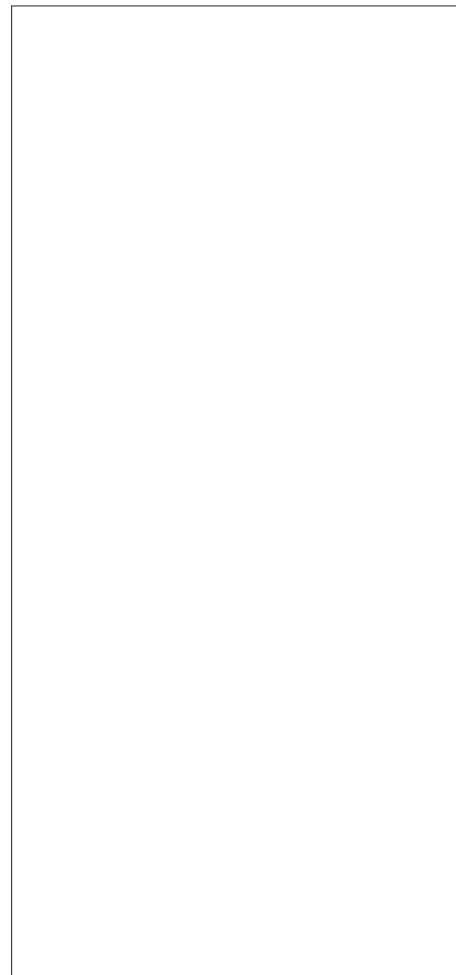

SAFETY PRECAUTIONS

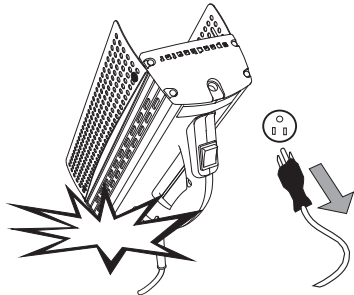

IF THE DEVICE IS EXPOSED TO A THRUST OR OTHER DAMAGE, IMMEDIATELY CUT THE POWER BY PULLING THE PLUG AND CHECK THE DEVICE'S ELECTRICAL COMPONENTS.



IMPROPER HANDLING OF THIS POWER TOOL MAY CAUSE FIRE: ALWAYS KEEP A FIRE-EXTINGUISHER AT HAND

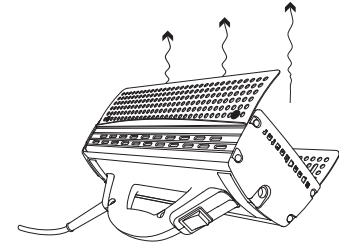

TURN OFF THE TOOL WHEN NOT IN USE . DURING TEMPORARY WORK BREAKS, ALWAYS TURN THE TOOL UPWARDS FROM THE SURFACE AND NEVER LEAVE IT UNSUPERVISED SINCE IT CONSTITUTES A FIRE HAZARD

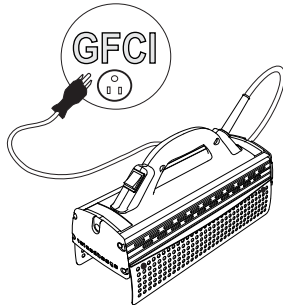

ALWAYS USE A POWER OUTLET WITH A GFCI (GROUND FAULT CIRCUIT INTERRUPTER) WHEN WORKING WITH THIS POWER TOOL.



METAL SURFACES ARE HOT WHEN IN USE. USE HEAT-PROTECTIVE GLOVES. ALWAYS USE A RESPIRATORY MASK AND/OR PROVIDE FOR GOOD VENTILATION. FOLLOW LOCAL LAWS AND REGULATIONS.

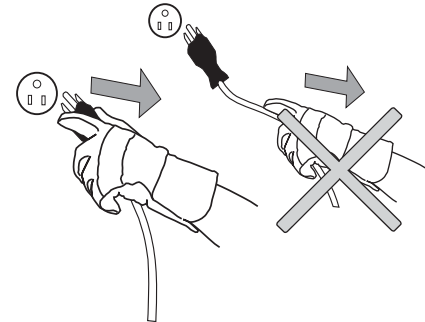

NEVER USE THE CORD TO CARRY THE TOOL OR PULL THE PLUG FROM AN OUTLET.

PERSONAL SAFETY

- 1. PREVENT FIRE HAZARD:** Always ensure there is a fire extinguisher close at hand. In case of fire, immediately switch the tool off and secure your safety.
Call an emergency number or a fire station immediately for assistance.
- 2. ELECTRIC SHOCK SAFETY:** Always avoid any bodily contact with grounded surfaces such as pipes, radiators, stoves or refrigerators. There is a risk of electric shock if your body is grounded.
An electric shock may cause severe personal injury or death.
- 3. ALWAYS USE A POWER OUTLET WITH A GFCI (Ground Fault Circuit Interrupter)** when working with this power tool. GFCI is designed to cut off the power when electricity is flowing through the ground wire. This is an excellent protection against electric shock. If you are required to meet OSHA and NEC standards, you must utilize a GFCI when working with any power equipment according to Federal United States law. If the tool is not connected to a proper outlet, you may receive an electric shock which may lead to severe injury or death.
- 4. GROUNDED TOOLS MUST BE PLUGGED INTO A PROPERLY INSTALLED OUTLET:**
Check with a qualified electrician if you are in doubt as to whether the outlet is properly grounded. Do not use any adapter plugs since this may cause fire or electrical shock that may cause injury or death. If the tool should malfunction, the ground provides a low resistance path to carry electricity away from the user. Grounded cords that comply with all codes and ordinances must be used.
- 5. APPROVED ACCESSORIES, PARTS AND SERVICE:**The use of accessories or systems other than those recommended in these instructions may cause personal injury, like as electric shock, fire or other. Use only original spare parts and accessories from the manufacturer for this tool. Using parts other than those specified in the spare parts list or otherwise approved by the manufacturer may cause personal injury and render the warranty invalid. The same applies to using non-approved or unauthorized service centers. The tool has been manufactured in accordance with prevailing regulations. Repairs should only be carried out by a properly qualified electrician to avoid the risk of personal accidents or injury.
- 6. ALWAYS USE THE ON/OFF SWITCH:** Disconnect the plug from the power source before making any adjustments. Always disconnect the power cord when not in use or when the tool is being serviced.
Failing to do this may lead to electric shock. Someone may also turn on the machine involuntarily, which can cause fire and or severe injury.
- 7. WORK SAFELY:** Ensure that a firm foothold can be obtained and that the work surface is stable.
Use the necessary safety equipment when working at heights. Firmly attach all anchoring points. If you intend to utilize ladders and scaffolding, follow the safety instructions of that equipment carefully. Always use appropriate safety equipment such as heat-protective gloves, a respiratory mask, eye protection, nonskid safety shoes and a hard hat, where appropriate in order to avoid damage. Follow local laws and regulations.
- 8. PREVENT BURNS:** Do not touch the tool's metal parts while in operation, since they become extremely hot and can cause personal injury. Also avoid touching already heated and loosened paint, putty and varnish, which can become hot as well. Always use appropriate safety equipment such as heat-protective gloves.





- 9. AVOID INHALING FUMES AND DUST:** Ensure effective ventilation and use a respiratory mask when working with paint or paint removal. Do this to eliminate the risk of inhaling possible toxic gases and dust. Follow local laws and regulations.
- 10. DO NOT EXCEED THE HEATING UP TIME.** If the paint is heated for too long and gets overheated the risk of exposure to toxic gases and fumes increases. Follow the Safety Manual for proper use. Always follow local laws and regulation.
- 11. DO NOT USE THE TOOL NEAR FLAMMABLE LIQUIDS OR GASES.**
Contact between the heat from the IR tubes or the gases and the electrical components in the machine may cause an explosion which may lead to personal injury or death.
- 12. KEEP CHILDREN AND PETS AWAY:** Do not let unauthorized people come in contact with this tool or power cord since this might constitute a fire hazard or risk of injury.
- 13. CHILDREN, PREGNANT OR POTENTIALLY PREGNANT WOMEN AND NURSING MOTHERS SHOULD NOT BE PRESENT IN THE WORK AREA UNTIL THE WORK IS DONE AND ALL CLEAN UP IS COMPLETED.** This is to avoid possible toxic gases or other substances that might be in the air or in the paint waste which might affect the child.

TO AVOID THE RISK OF FIRE

- 14. NEVER LEAVE THE TOOL UNSUPERVISED:** The power tool should never be left unsupervised when in operation. After use, it should be switched off and allowed to cool to a safe temperature before being left unattended. Leaving the tool unsupervised might cause fire or damage on other property.
- 15. LIMIT THE HEATING- UP TIME:** Heating a surface for too long or leaving the power tool unattended may cause fire or damage the machine or the surface. A surface should be heated only for 20 - 30 seconds indoors and 20 40 seconds outdoors. Apply only enough heat to make the paint pliable. The paint is ready to be scraped off when it is both bubbling and smoking at the same time.
- 16. KEEP THE WORK AREA CLEAN:** Untidy surfaces and work areas increase the risk of fire and personal injury.
- 17. WE RECOMMEND HAVING A WATER SPRAYER** handy to spray mist into cracks and crevices as a precaution against overheating that may lead to fire. Slightly wetting the painted surface prior to paint removal is advantageous and will aid the paint removal process and significantly reduce the risk of fire. The power tool will dry out the moisture you previously introduced, making the wood dry and ready for the primer coat and paint.

OTHER WARNINGS

- 18. EXTENSION CORDS:** Always use extension cords approved for the required amperage and environmental conditions or an electric overload may develop, which might lead to a short circuit.
- 19. DO NOT EXPOSE THE TOOL TO RAIN:** Do not use this tool in damp or wet places.
If the machine gets wet it may cause short circuit.
- 20. DO NOT ABUSE THE POWER CORD:** Never use the cord to carry the tool or pull the plug from an outlet. Keep cord away from heat, oil, sharp edges or moving parts. Replace damaged cords immediately. Damaged cords increase the risk of electric shock. Make sure the power cord is not in contact with any of the hot surfaces on the tool. This could destroy the cord and cause electric shock.
- 21. TOOL MAINTENANCE:** Keep the tool clean and dry. Take special care to ensure that the infrared tubes and aluminum reflectors are clean and in working order. Dirty tubes and reflectors will reduce efficiency and can cause fire. Check the power cord, safety shields, and other parts regularly. Replace damaged parts. The IR tubes are made of quartz glass and must be handled with care. Always use gloves or a rag when handling the IR tubes. Never touch them with your hands. If an IR tube breaks, immediately switch the power tool off, pull the plug and replace the tube. Do not operate with only one tube working. Improper tool maintenance may lead to malfunction, fire hazard, risk of electric shock and thereby personal injury.
- 22. CHECK DAMAGED PARTS:** Before continuing to use this tool, carefully check all safety systems and other damaged parts to ensure the tool will function properly for the intended task.
The safety system or other damaged parts should be repaired or replaced immediately.
- 23. DUST PARTICLES:** Although this power tool does not create dust itself, scraping the soft paint might release dust particles that may contain lead. Clean up all removed paint and dust by wet mopping the floors. Use a wet cloth to clean all walls, sills and any other surfaces where paint or dust is clinging.
Use an environmentally safe cleaning detergent. Place a drop cloth or tarpaulin under the work area to catch any paint chips or peelings. Wear protective clothing. At the end of each session, put the paint waste and debris in a double plastic bag, close it with tape or twist ties and dispose of properly. Follow local laws and regulation. Use respiratory mask and heat-protective gloves. Keep interior work area well ventilated.
- 24. HANDLING THE POWER TOOL:** Dropping this tool may cause irreparable damage to the housing and infrared tubes. IR tubes are the most sensitive parts of this tool and will break if dropped.
Cracked IR tubes and/or damage to the housing void the warranty. It is recommended that a suspension system be used for removal of paint on exterior walls, which will reduce the risk of dropping the tool and causing damage to it. Various hands-free systems are available from the distributor and/or the dealer who sold you the Speedheater Infrared Paint Remover, model 1100.



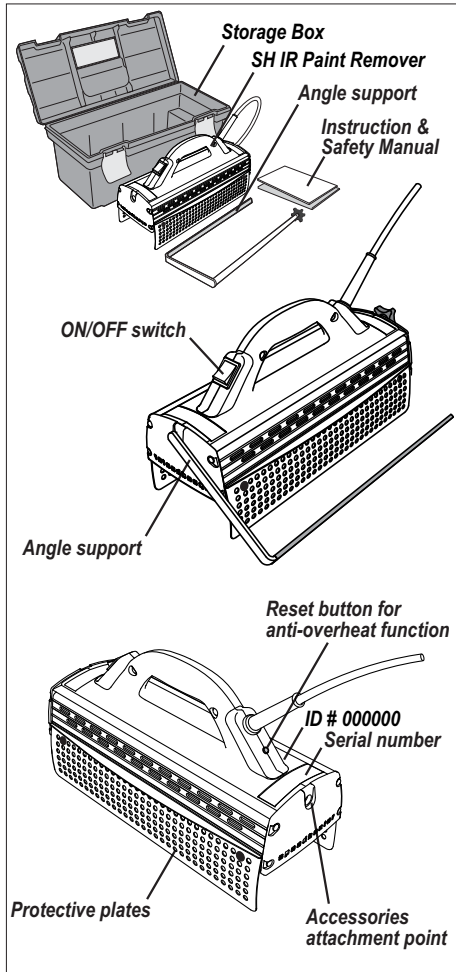

TECHNICAL SPECIFICATIONS

Speedheater Infrared Paint Remover, model 1100

This tool is made in Sweden by Speedheater Systems AB.



CE in accordance with EN 60335-1, EN 60335-2-45 standards.

Connection

1 phase standard grounded outlet.

Volts	Watts	Amps	Cord
120	1100	9.2	16 gauge 3 wire, 8 feet long.

Anti-overheat function

The anti-overheat feature only protects the components of the tool from being overheated. It does not monitor the temperature of the substrate or protect against fire hazards.

Dimensions

Storage Box		IR Paint Remover		Heating surface	
Total length :	20"	Total length:	14 1/2"	Length:	12 1/4"
Width :	10 1/4"	Width:	6 3/4"	Width:	4 7/8"
Height :	9 1/2"	Height:	6 3/8"		
		Approx. Weight:	4 lb 3 oz.		

Optimum exposure time for paint removal applications

Indoors 20 to 30 seconds.

Outdoors 20 to 40 seconds.

The paint is ready to be scraped off when it is both bubbling and smoking simultaneously.

Operating Temperature

Approximately 200 - 400° F (100-200°C) when used as described in the instructions. Heating for longer than recommended increases the temperature and may thereby constitute a fire hazard, exposure to lead vapor and other vapors that may cause severe personal injury.

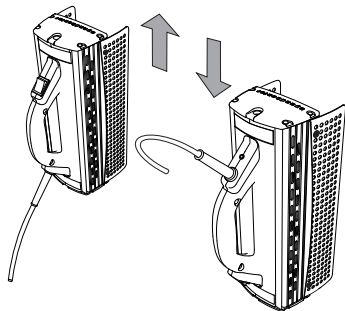

When heating in vertical angle, turn the machine around after 2 hours. For keeping even effect on ir bulbs.



Reset button for anti-overheat function

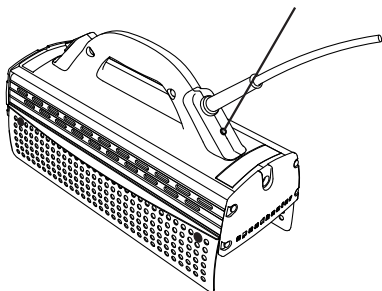

INSTRUCTIONS FOR USE

General information before you start

Make sure the protective plates are in facing down before you turn the power tool on. Never obstruct the airflow through the vented shields. Clean the shields if they get obstructed in any way.

When doing a window restoration, place the Speedheater 1100-15 in an angle with the help of the angle support. Begin heating paint and putty for about 1-2 minutes. Putty takes longer to soften than paint and even if the paint surface has bubbled up, it is good to wait close to 2 minutes for the putty to soften.

The temperature required to remove paint, is significantly less than you may expect. Heat the paint only to the point when it can be easily scraped off. Indoors 20-30 seconds, outdoors 20-40 seconds. The paint is ready to be scraped off when it is bubbling and smoking simultaneously.

Variables concerning heatingtime

- Ambient temperature. (Colder temperature will increase time.)
- Wind will increase exposure time. (Outdoor applications.)
- Type of paint. (Acrylic paint needs a shorter heating time.)
- Layers of paint (Many layers will increase heating time.)

Anti-overheat function

The Speedheater Infrared Paint Remover has a shut off function to prevent overheating. The anti-overheat feature only protects the components of the tool from being overheated. It does not monitor the temperature of the substrate or protect against fire hazards.

If the anti-overheat function is triggered, power to the unit will be cut and the light on the ON/OFF switch will go out. The safety switch only comes out approximately 1 mm.

Switch the unit OFF, place it with the heating surface facing up and allow it to cool completely. When cool, reset the anti-overheat function by pressing the button beneath the power cable.

Start the tool up again, according to the "Connecting and heating up" instructions.

Preparations

- Ensure the work area is clean and free of flammable materials, liquids and gases.
- Make sure ladders, platforms and scaffolds are properly and safely erected.
 - Follow the manufacturer's mounting and installation instructions meticulously in order to avoid personal injury.

Old dried out paint and acrylic paint.

- Paint pigment alone is not sensitive to heat. So to be able to remove very old and dried out paint, a solution of 80% boiled linseed oil and 20% white spirits (Naphtha Hydrotreated Light) can be applied on the dry surface. Apply the solution using either a paintbrush or spray bottle at least one hour before stripping any paint. This mixture will help dry paint become more sensitive to infrared heat, making it soft for easier scraping.

Connecting and heating up

- Connect the cord to a 120 V grounded outlet.
 - Always use a power outlet with a GFCI (Ground Fault Circuit Interrupter) when working with the Speedheater Infrared Paint Remover, Model 1100.
 - If using an extension cord, ensure it is approved for both the amperage and the environmental conditions. Move the switch to the ON position, and set the tool down with the heat surface facing up.
- Make sure that the tool is placed away from any surface or flammable materials when heating and never leave it unsupervised.
- When the machine is heated up and ready for use, the tubes will glow bright orange. Heating-up time is approximately 2 minutes.

Paint stripping

- When the machine is properly warmed up, you can start to heat the paint by turning the Speedheater Infrared Paint Remover to face the work surface, holding it in position with a firm grip. Wait until the paint is completely soft, i.e. smoking and bubbling.
 - Heating-up time indoors is 20 to 30 seconds and outdoors it is 20 to 40 seconds. To find out how much time your specific application requires, begin with a short heating time and extend it if needed. For different variables affecting heating time, see page 11 in the General Information section.
- When the paint is smoking and bubbling, move the tool to a new area. Scrape the paint from the first area while the next area is heating up.

During temporary work breaks, the tool must always be turned upwards from the surface and never left unsupervised (see diagram).

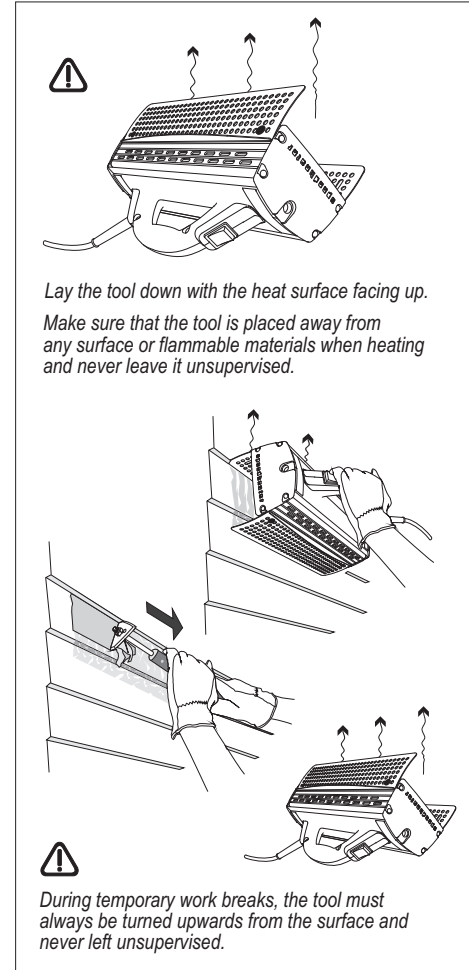

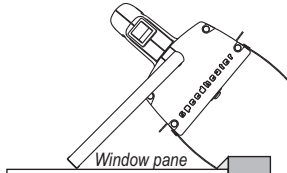

Diagram 1.

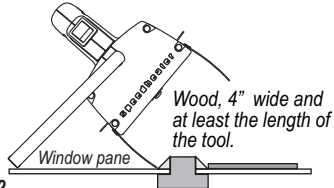

Diagram 2.

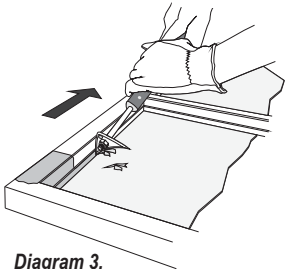

Diagram 3.

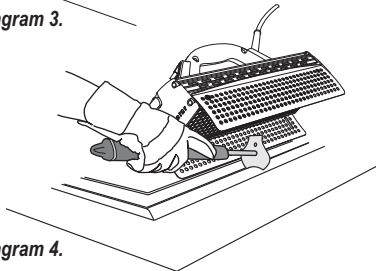
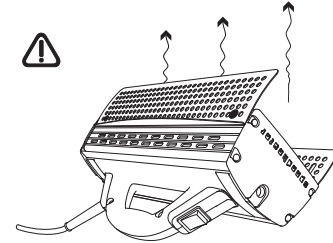

Diagram 4.

- **When restoring windows**, be extra gentle in order to protect the glass. Make sure the bottom shield edge of the tool is placed along the edge of the putty you intend to remove. Avoid directing infrared heat onto the glass. See Diagram 1.
- First remove the paint and then the window putty using a putty chisel, for example. It is possible to reheat the paint and putty. Heating time depends on the properties of the wood, the putty, type of paint and climate conditions.
- When working on window sash mountings, use a thin piece of wood covered with aluminum foil or aluminum tape. It reflects heat radiation and prevents cracking of the facing glass, see Diagram 2.
 - It is very helpful to always use high quality scrapers for efficient paint removal.
 - For an even better results, use scrapers that you place on the surface and pull towards you, see Diagram 3.
- When removing paint from textured surfaces, use the angle support and scraper as shown in the diagram 4.
 - Remember that the metal parts of this power tool are very hot and may cause burns if you come into contact with them. Always use heat-protective gloves.
 - It is important to remember that working on a surface under the Speedheater Infrared Paint Remover is never necessary but might facilitate scraping heavily profiled surfaces.

Switching off

- Move the switch to the OFF position.
- Set the tool down with the heating surface facing up and allow to cool.
 - Do not leave the tool unattended until it has completely cooled and make sure that there are no flammable materials close by.
- Disconnect the power cord during breaks and when work is complete.
- **Do not place the tool in the carrying case before it has completely cooled down.**



*Set the tool down with the heat surface facing up.
Make sure that the tool is placed away from
any surface or flammable materials when heating
and never leave it unsupervised.*

TROUBLESHOOTING GUIDE

Problem	Likely cause	Solution
Tool does not turn on	Tool not plugged in The anti-overheat function is not reset The electrical devices in the machine have been damaged The fuse has been blown	Plug the cord into a 15 amp outlet Reset the anti-overheat function by pressing the button beneath the power cable. Check the damage and let an authorized electrician make the necessary repairs. Change the fuse that goes to the outlet you are using.
Tool turned off after it was on	Tool overheated and the anti-overheat function shut the tool off	Let the tool cool down for at least 15 minutes or until it has cooled and press the small button below the power cord. You will hear a clicking sound.
Fuse blows or circuit breaker trips	There has been a short circuit caused by broken tubes or the power iscord damaged.	Have the tool inspected by an authorized person to find out where the short circuit is. Repair the tool with Speedheater Systems AB approved components.

CLEANING AND MAINTENANCE

Always ensure the power cord is disconnected from the electric outlet and the tool is completely cooled before beginning any cleaning or maintenance work.

In order to maintain the product's safety and efficiency, the IR tubes and reflectors must be kept clean. The IR tubes and reflectors can be wiped using a cloth moistened with Denatured Ethanol.

Ensure that the Power Tool has completely cooled down.
Remove the safety grid by undoing screws ① at each end.
Carefully wipe accessible parts of the tubes, reflectors and the safety grid.
Replace the grid and ensure that the screws are seated tightly.
Avoid scraping with sharp objects.

Always use protective gloves.

CHANGING IR TUBES

The IR tubes are made of quartz glass and must be handled with care. If an IR tube breaks, immediately switch the tool off, pull the plug from the wall socket and replace the tube.

Always use gloves or a rag when handling the IR tubes. Never touch them with your hands.

Repairs should be carried out only by a properly qualified electrician to avoid the risk of accidents or injury.

The tubes are hot during operation and take some time to cool off. Before changing any tubes, make sure they have cooled. Always use heat-protective gloves in order to avoid burning and cutting injuries.

When changing the IR tubes you need to secure the handle of the Power Tool firmly in a vice with a cloth around the handle so that when you turn the plinth screws you don't move the tool. To remove the screws for the wires you need a flat head 1/8" wide screw driver. The wrong size screw driver will crack the ceramic plinth and/or strip the screw heads. When reassembling, make sure not to over tighten any of the screws.

- Remove the safety grid by loosening the screws on each end ①.
- Unscrew the safety grid ② and the reflector flanges ③.
- Detach the IR tube cable connections by undoing the screws on the connection plinths ④.



Repairs should be carried out only by a properly qualified electrician to avoid the risk of accidents or injury.

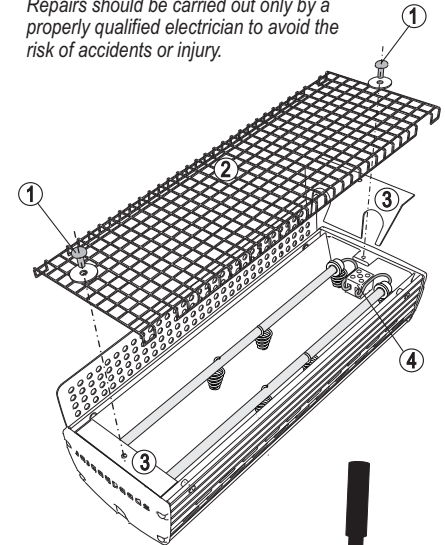

*Flat head 1/8" wide screw driver.
⊖ (4 mm)*

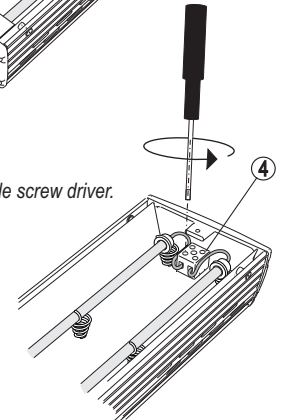

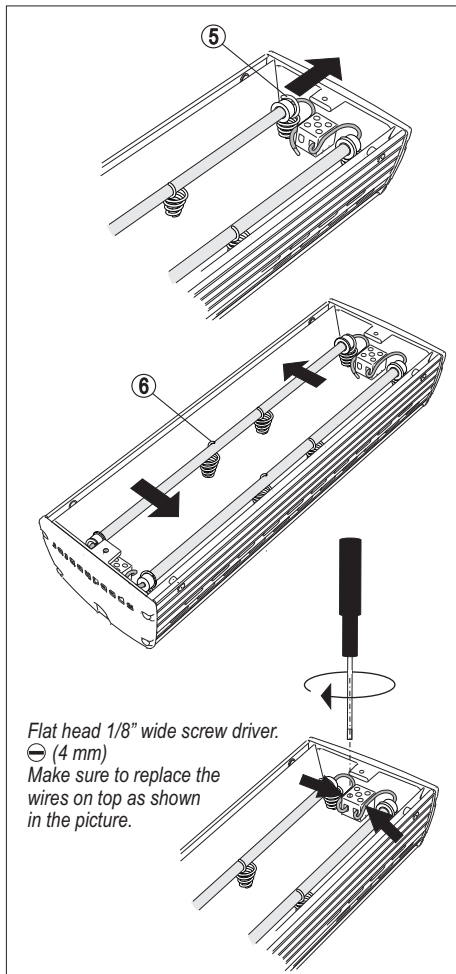

- Carefully loosen the spring holders (5) in the outer ends in order to loosen the ceramic ends of the IR tubes.
- Turn the tube in the direction shown in the drawing until the tube is released from the middle spring holders (6).

Handle broken tubes very carefully to prevent anyone getting hurt.
 Dispose of the IR-tubes appropriately.

A new IR-tube is inserted in the opposite order from the steps above (6-1).

- Carefully insert and turn the tube into the spring holders in the middle (6).
- Carefully fasten the outer spring holders (5) on the ceramic ends of the tube.
- Attach the cables to the connection plinths (4) and tighten the screws firmly, but not so hard that they break.
- Make sure the cables are firmly fastened in the right way according to the picture.
- Refasten the reflector flanges (3), the safety grid (2) and retighten the screws (1) on each end.

Turn the machine on and test warm it with the heating area turned upwards.
 The tubes shall have an even soft red/orange color tone.
 If you have changed only one tube, a small color difference might occur.

IMPORTANT!

Always use original tubes designed for this model of Speedheater IR Paint Remover.

If you do not have the proper competence for this kind of activity, talk to a professional or the store where you bought the machine.

SPARE PARTS LIST

The Speedheater Infrared Paint Remover, model 1100.

Repairs should be carried out only by a properly qualified electrician to avoid the risk of accidents or injury.

When ordering spare parts, always give the Power Tools serial number and the part name and number.

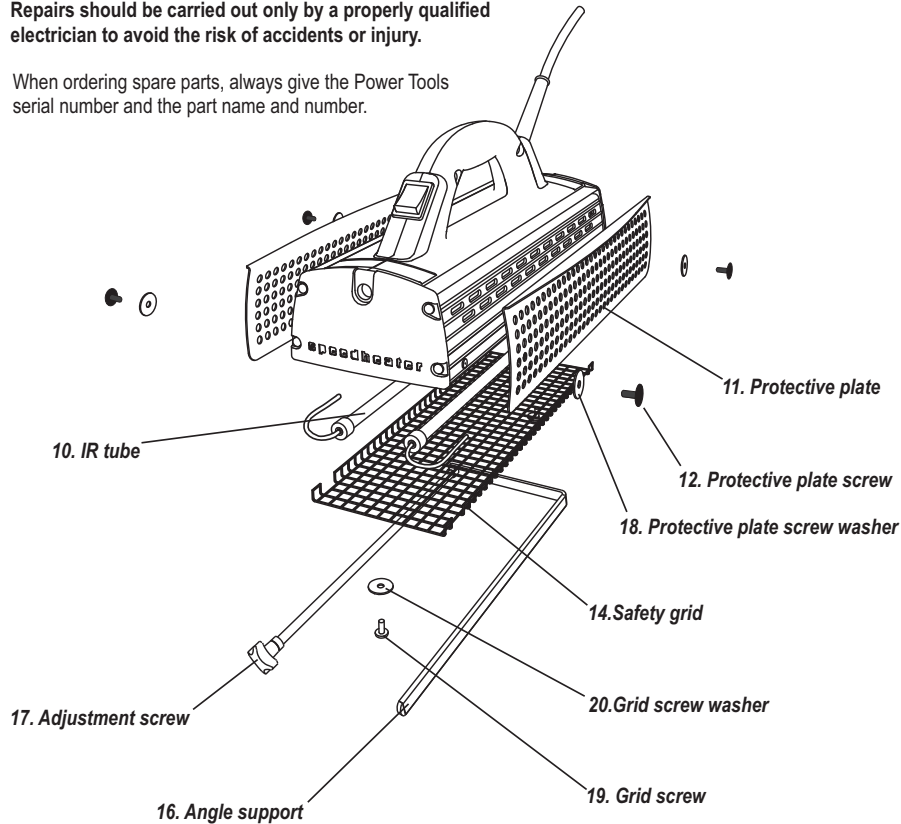

The design of the tool is subject to changes without prior notice.

One Year Warranty

Speedheater Systems AB
hereby warrants that the Speedheater
IR Paint Remover, model 1100, is covered
by the terms in this limited warranty
against defects in material and workmanship
and it applies to one year from the date
when a sale was invoiced.
The limited warranty does not cover the
normal wear and tear of products.

ONE YEAR LIMITED WARRANTY

1. Speedheater Systems AB hereby warrants that the Products fully comply with the technical specifications in the technical manuals and are covered by the terms of this limited warranty against defects in material and workmanship, provided that any allegedly defective Product has not been altered, misused, neglected or damaged through causes unconnected with its manufacture.
2. The limited warranty hereto applies for 1 (one) year from the date when a sale was invoiced. Faults of quality and hidden defects which cannot be verified immediately upon delivery shall be communicated in writing within 8 (eight) days from discovery thereof. Returns of Products shall be made with proof of purchase to location where it was purchased, but shall not be made without the authorization of the Dealer/Distributor. The limited warranty hereto does not cover the normal wear and tear of products.
3. The limited warranty does not apply to damages caused during transportation (including transport to and from the owner), or damage due to improper or lack of maintenance, voltage overloads or "undervoltage", insufficient or abnormal operation of electrical systems, or in general any cause which does not specifically depend on defects in material or workmanship, or if the serial number on the product has been removed, altered or defaced.
4. This limited warranty provides for the replacement of the Products and/or of the assessed defective parts thereof according to their availability, within about 90 (ninety) business days of receipt by Speedheater Systems AB of the defective Products or parts, delivered to the same location and in the same condition and packaging provided in the original delivery. In case of defects or non-compliance of the Products, Speedheater Systems AB shall have up to 90 (ninety) business days to remedy the situation. In no event shall an authorized dealer or retailer of Speedheater Systems AB products be entitled to reduce the price of the Speedheater Systems AB products as a consequence of defects and/or non-compliance of the products without Speedheater Systems AB's written consent.
5. EXCEPT AS EXPRESSLY PROVIDED IN THIS LIMITED WARRANTY, SPEEDHEATER SYSTEMS AB HEREBY DISCLAIMS ALL WARRANTIES, EXPRESS, STATUTORY AND IMPLIED, APPLICABLE TO PRODUCTS, INCLUDING, BUT NOT LIMITED TO, ANY WARRANTY OF MERCHANTABILITY OR FITNESS FOR A PARTICULAR PURPOSE AND ANY WARRANTY THAT ANY PRODUCT IS DELIVERED FREE OF CLAIMS OF THIRD PARTIES BY WAY OF INFRINGEMENT OR THE LIKE.
6. SPEEDHEATER SYSTEMS AB FURTHER DISCLAIMS ALL EXPRESSED, STATUTORY AND IMPLIED WARRANTIES APPLICABLE TO PRODUCTS WHICH ARE NOT MANUFACTURED BY SPEEDHEATER SYSTEMS AB. THE ONLY WARRANTIES APPLICABLE TO PRODUCTS NOT MANUFACTURED BY SPEEDHEATER SYSTEMS AB SHALL BE THE WARRANTIES, IF ANY, OF THE MANUFACTURER OF THOSE ITEMS.

7. The total liability of Speedheater Systems AB for any loss, damage or claim, whether in contract, tort (including Speedheater Systems AB's active or passive negligence or strict liability) or otherwise, arising out of, connected with, or resulting from the performance or breach of any distribution agreement, subdistribution agreement, or sale agreement, or purchase order, or contract of sale accepted or executed by Speedheater Systems AB, or from the design, manufacture, sale, delivery, resale, inspection, assembly, testing, repair, replacement, operation, maintenance or use of any Product or from the performance of any service shall not, in any event, exceed the price allocable to the product or service which gives rise to the claim, loss or damage.

8. IN NO EVENT, WHETHER AS A RESULT OF BREACH OF CONTRACT OR WARRANTY OR ALLEGED NEGLIGENCE OR STRICT LIABILITY, SHALL SPEEDHEATER SYSTEMS AB BE LIABLE FOR INDIRECT, INCIDENTAL, CONSEQUENTIAL, SPECIAL OR EXEMPLARY DAMAGES, INCLUDING, WITHOUT LIMITATION, LOSS OF PROFITS OR REVENUE, LOSS OF PRODUCTS OR ANY ASSOCIATED EQUIPMENT, COST OF CAPITAL, COST OF SUBSTITUTED EQUIPMENT OR PARTS, FACILITIES OR SERVICES, DOWNTIME COSTS, LABOR COSTS, OR CLAIMS OF CUSTOMERS OR SUBDISTRIBUTOR.

9. IF ANY PORTION OF THIS LIMITED WARRANTY IS HELD ILLEGAL OR UNENFORCEABLE BY REASON OF ANY LAW, SUCH PARTIAL ILLEGALITY OR UNENFORCEABILITY SHALL NOT AFFECT THE ENFORCEABILITY FOR THE REMAINDER OF THIS LIMITED WARRANTY WHICH IS AND WILL ALWAYS BE CONSTRUED TO BE LIMITED BY ITS TERMS OR AS LIMITED AS THE LAW PERMITS.

10. As a prior condition to any obligation of Speedheater Systems AB under the above limited warranty, the purchaser of Speedheater Systems AB's products must have fully and finally paid for the products. The above warranty does not cover normal wear and tear of the Speedheater Systems AB's products.

11. Speedheater Systems AB shall have no obligation under the limited warranty unless it is established to the satisfaction of Speedheater Systems AB that the Speedheater Systems AB' product (i) has not been altered or modified without the prior written consent of Speedheater Systems AB, (ii) has been assembled, maintained, operated and used at all times in accordance with Speedheater Systems AB's current, applicable operation, maintenance and other written instructions issued from time to time by Speedheater Systems AB, and (iii) has been used only with parts specifically approved by Speedheater Systems AB for use with Speedheater Systems AB's product.

12. This Limited Warranty distributes the risk of product failure between purchaser and Speedheater Systems AB, and Speedheater Systems AB's product pricing reflects this distribution of risk and the limitations of liability contained in this Limited Warranty. The agents, employees, distributors, and dealers of Speedheater Systems AB are not authorized to make modifications to this Limited Warranty, or make additional warranties binding on Speedheater Systems AB. Accordingly, additional statements such as dealer advertising or presentation, whether oral or written, do not constitute warranties by Speedheater Systems AB and should not be relied upon.